

# Crushers – Shredders B400 / 370 – 510 – 750 series, 2 rotors

## **Volume reduction & destruction of ordinary or special waste materials**

Because of their wide range of configurations possibilities, they can easily be adapted to suit an industry's or community's domestic waste and packaging needs.

The B400 series includes models of a power of 11 kw, and of a cutting width from 370 to 750 mm



Crusher BLiK B400  
output endless screw



BLiK B400 crusher in a standard version for volume reduction and destruction of ordinary waste, O.M., packaging, production waste



BLiK B400 Crusher, conveyor,  
Reception containers



BLiK articulated hopper facilitates  
and accelerates feed crusher

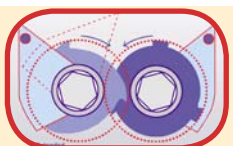

# BLiK



www.blik.fr

**BLiK - Waste Recovery  
and Processing Equipment**  
Z.I. de Chenet  
91490 MILLY-LA-FORET  
E.mail: blik@blik.fr

**telephone:**  
33 (0)1 64 98 79 79  
**fax:**  
33 (0)1 64 98 79 78



BLiK B400-510 crusher on 660 litre container



BLiK B400 crusher, community version

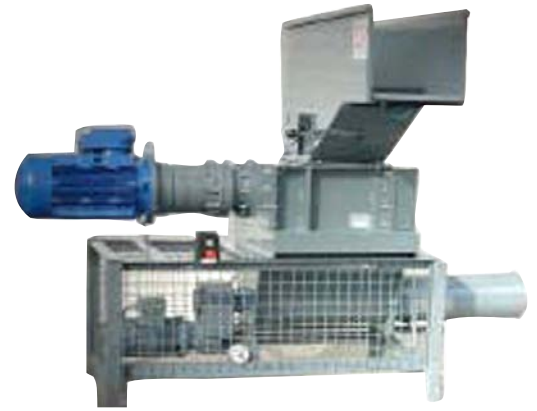

BLiK crusher, special "fireproof" version for petrol tanks



BLiK B400 destruction of files without preparation



**(FREE AND ENVIRONMENTALLY FRIENDLY PACKAGING SHEETS)**

BLiK B400 crusher, non stop screw output and bag for destroying cardboard packaging without flattening. Excellent for making packaging sheets.



Optional: screw removal, filling Big Bag



supply option by elevator belt



*Perfect hygiene, zero corrosion?*  
**Solution: STAINLESS STEEL BLiK (optional)**



Stainless steel: cutting block and blades.

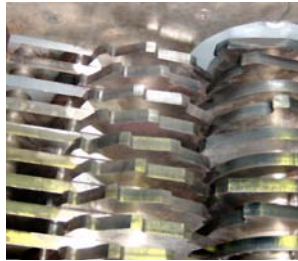

Stainless steel: blades

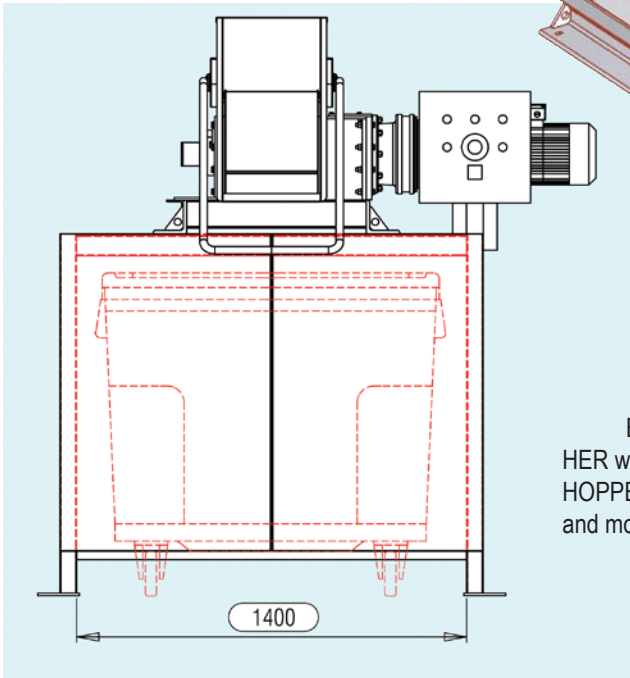
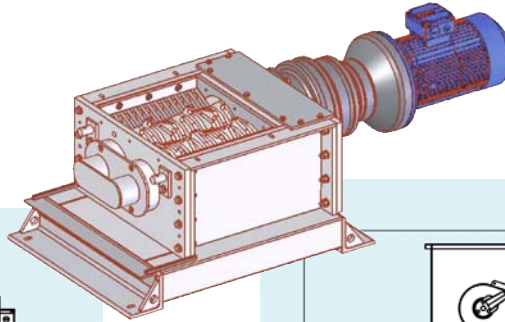
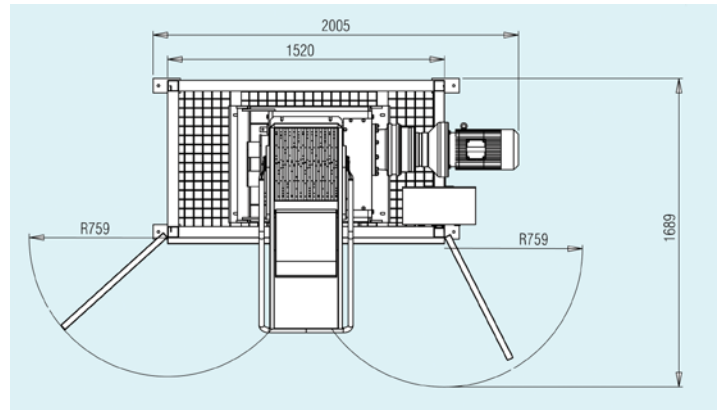

BLiK B400 CRUSHER with ARTICULATED HOPPER: loading faster and more comfortable

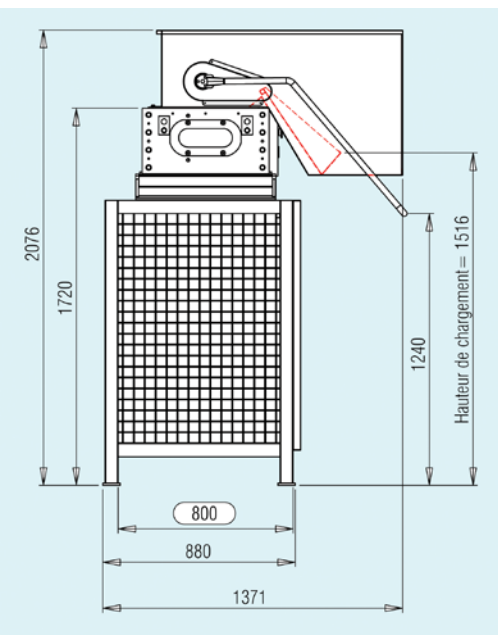
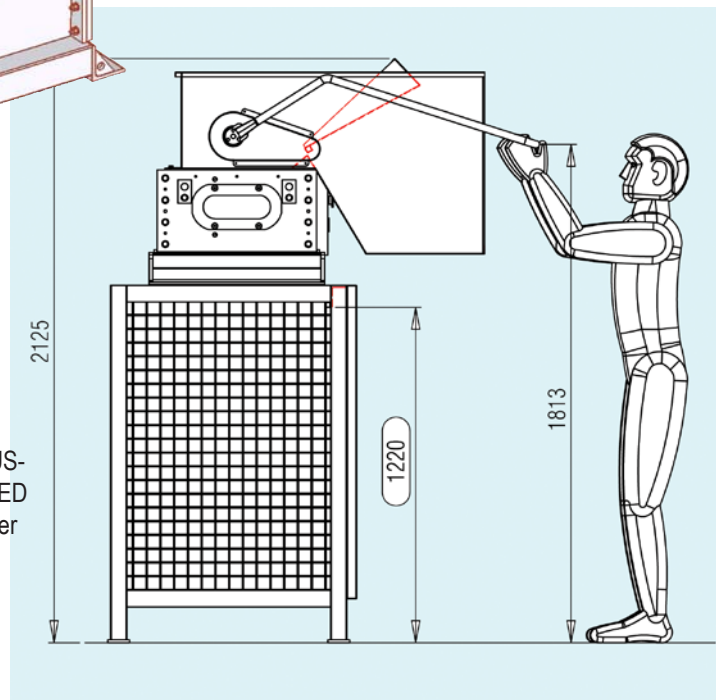

Summary of BLiK crushers - B400 series			
(*)	B 400 Series TECHNICAL SPECIFICATIONS		
Model	B 400 / 370	B 400 / 510	B 400/750 (**)
Cutting assembly	420 x 370 mm	420 x 510 mm	420 x 750 mm
Power kW	11 230/400 V Tri 50 hz	11 kW 230/400 V Tri 50 hz	9 - 11 kW 230/400 V Tri 50 hz
Hopper volume (**)	100-170 L	150-200 L	200-250 L
Dimensions (mm) with Chassis - L x P x H. (**)	1390 x 1560 x 2000	1390 x 1560 x 2000	1390 x 1560 x 2400
Blade width	200-220	200-220	200-220
Blade thickness	8-6 ou 4 Standard GC	8 - 12 Standard GC x 3	8 - 12 Standard GC x 3
Electronic control	Automate télémechanique	Automate télémechanique	Automate télémechanique
Weight	approx. 500	approx. 600	approx. 700
Made in France - "CE" certified – 1 year guarantee			
(*) Subject to technical and optical modifications      (**) depending on use and plant			